

D15.1.22,			
VS	Predsieň		5,07
KP	Kúpeľňa		4,91
OI	Obývacia izba		16,83
K	Kuchyňa		4,50
SP	Spálňa		13,60
CH	Chodba		3,32
KO	Komora		1,89

Celková plocha bytu 50,12 m<sup>2</sup>

D15.1.22, ext.,			
B	Balkón		4,97

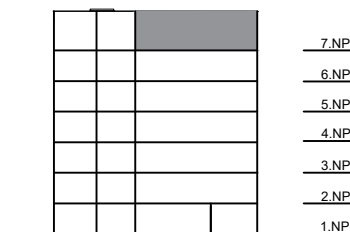
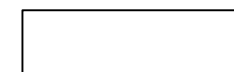

7.NP

6.NP

5.NP

4.NP

3.NP

2.NP

1.NP